

Tolerances Unless Otherwise Stated			Tolerances of Angle (Shortside of Angle)			Surface Finish	Dimension	Tolerance
up to 6	over 6 up to 30	over 30 up to 120	up to 10	over 10 up to 50	over 50 up to 100			
±0.1	±0.2	±0.3	±5'	±30'	±20'			

30mm

Fuer diese Zeichnung behalten wir uns alle Rechte nach DIN 34 for.

DRAWING CREATED WITH ISO STANDARDS

THIS DOCUMENT AND ALL INFORMATION THEREIN CONTAINED ARE OUR EXCLUSIVE PROPERTY. THE RECIPIENT AGREES NOT TO REPRODUCE, COPY, USE OR TRANSMIT THIS DOCUMENT AND/OR THE INFORMATION THEREIN CONTAINED FOR ANY PURPOSE, EXCEPT WITH OUR WRITTEN PERMISSION.

NOTES:

- 1 MEASURE THIS DIMENSION WITH SHAFT PUSHED TOWARDS BRUSH END OF MOTOR.
- 2 STAMP WITH PRODUCTION DAY AND YEAR.
- 3 AXIAL ENDPLAY: 0,05-0,6.
- 4 REAR SHAFT EXTENSION 0,55mm MAX.
- 5 POLARITY MARK INDICATES POSITIVE TERMINAL AS SHOWN.

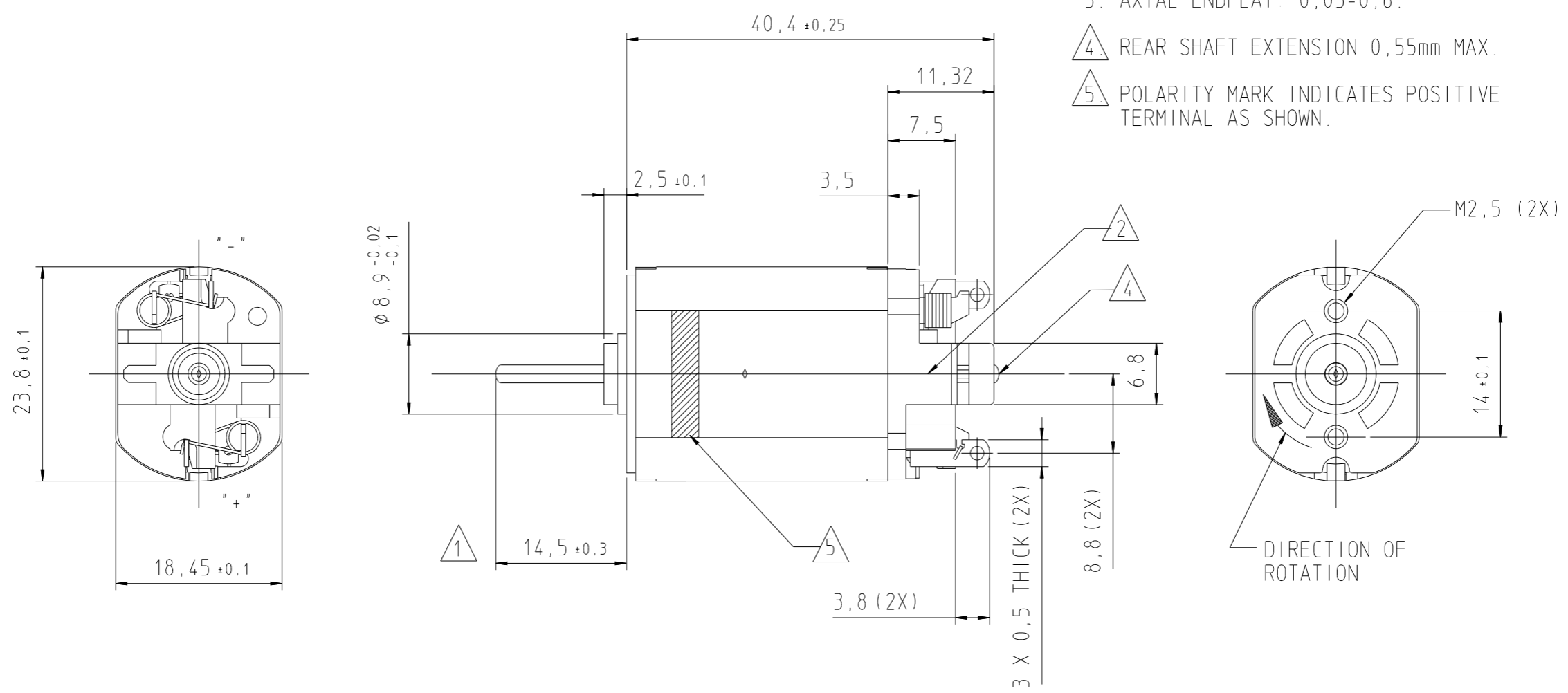

-	038
-	030
PI	KN

		ISO-E		N/A		Internal	
				Material Number		B	X
				Date		07MAR95	Substituted For
				Drawn		HERRING	-
				Check		JEH	Replaced By
				Appr.		-	-
				Title			Scale
				MOTOR DIMENSIONS			2:1
				Exper. No.			-
				Drawing Number			Sheet
				7.27.838.KN (3)			1
				16.25			of
				-			1
DI	Change Only With CAD	Date	Name	Use			

1			2			3				
TOLERANCES UNLESS OTHERWISE STATED			FILLET RADIUS AND CHAMFER HEIGHT			SURFACE FINISH			DIMENSION	TOLERANCE
UP TO 6	OVER 6 UP TO 30	OVER 30 UP TO 120	UP TO 3	OVER 3 UP TO 6	OVER 6 UP TO 30	$\sqrt{R_z}$ -			-	-
±0.1	±0.2	±0.3	±0.2	±0.5	±1				-	-

SUPPLIER MUST CONFORM TO QAR-200 INCLUDING QAR-200 SPECIAL QUALITY REQUIREMENTS (SQR).

CHARACTERISTICS IDENTIFIED BY THIS SYMBOL HAVE SPECIAL QUALITY REQUIREMENTS AS IDENTIFIED BY THE ACCOMPANYING QAR-200 SPECIAL QUALITY REQUIREMENT DOCUMENT. NOT APPLICABLE

PARAMETERS IDENTIFIED BY THIS SYMBOL ARE SPECIAL CHARACTERISTICS.

1.0 GENERAL

THE FOLLOWING VALUES ARE VALID AT AMBIENT TEMPERATURES OF 20 TO 25°C. THE MEASUREMENTS SHALL BE DONE FAST ENOUGH TO EXCLUDE ANY HEATING EFFECTS. THE MEASUREMENTS SHALL BE TAKEN WITH MOTOR SHAFT IN A HORIZONTAL POSITION.

2.0 MECHANICAL DIMENSIONS

- 2.1 DIMENSIONS ACCORDING TO DRAWING 7.27.838.KN
- 2.2 DIRECTION OF ROTATION ACCORDING TO DRAWING 7.27.838.KN
- 2.3 AXIAL AND RADIAL PLAY ACCORDING TO DRAWING 7.27.838.KN
- 2.4 MOTOR SURFACE AND SHAFT TO BE FREE OF CORROSION

3.0 MOTOR CHARACTERISTICS

- 3.1 NO LOAD CONDITION
 - Vt = 12.0 VDC
 - No = 5800 RPM ± 10%
 - Io = 85 mA MAX
- 3.2 LOAD CONDITION
 - Vt = 12.0 VDC
 - Tl = 0.30 Ncm
 - Nl = 4510 RPM ± 15%
 - Il = 0.26 mA MAX

3.3 HI-POT TEST

MOTOR MUST WITHSTAND 150 VRMS BETWEEN MOTOR HOUSING AND ANY TERMINAL FOR 1 SECOND WITHOUT BREAKDOWN.

-	038
-	030
PI	KN

THIS DOCUMENT AND ALL INFORMATION THEREIN CONTAINED ARE OUR EXCLUSIVE PROPERTY. THE RECIPIENT AGREES NOT TO REPRODUCE, COPY, USE OR TRANSMIT THIS DOCUMENT AND/OR THE INFORMATION THEREIN CONTAINED FOR ANY PURPOSE, EXCEPT WITH OUR WRITTEN PERMISSION.

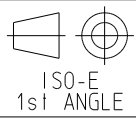

MATERIAL		INTERNAL	
-		B	X
MATERIAL NUMBER		X	X
BUEHLER MOTOR	DATE	10MAY00	SUBSTITUTED FOR
INC.	DRAWN	HERRING	-
CARY, NC 27512	CHECKED	JEH	REPLACED BY
	APPROVAL	-	-

TITLE		A4	
MOTOR SPECIFICATIONS		SCALE	SHEET
DRAWING NUMBER		N/A	1
7.13.839.KN			OF 1
2	REDRAWN PER ECO 4113-10	10MAY00	JEH
EXPERIMENTAL NUMBER		EX.XXX.XXXXX	
DI	CHANGE ONLY WITH CAD	DATE	NAME
		USE	16.25

30mm

Fuer diese Zeichnung behalten wir uns alle Rechte nach DIN 34 for.

DRAWING CREATED WITH ISO STANDARDS